

ZONEREV		DESCRIPTION	DATE	APPROVED
-	A	ORIGINAL ISSUE	GMF	03 MAY 07

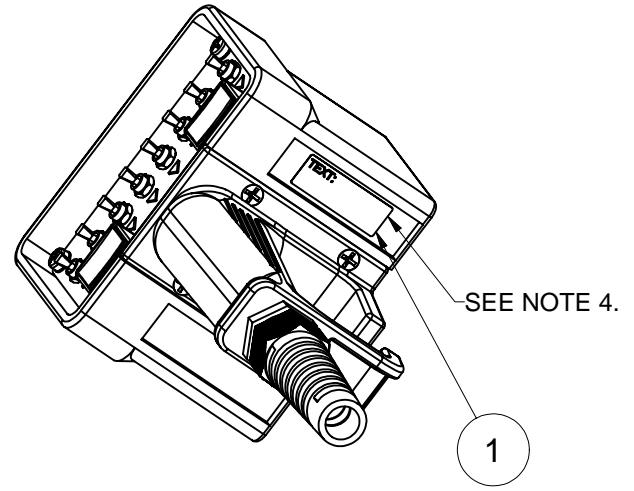
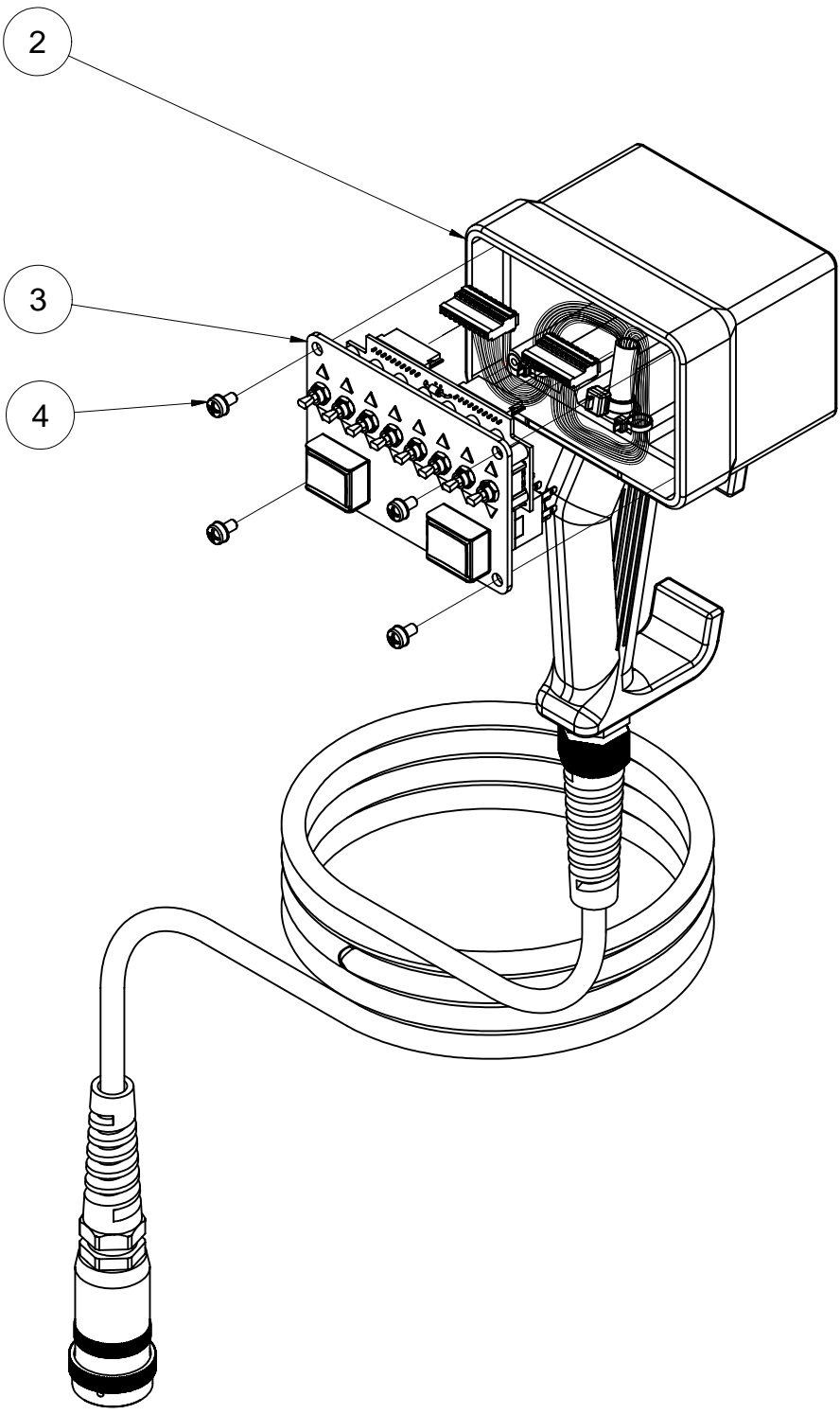

ITEM	QTY	PART NUMBER	DESCRIPTION
4	4	1900-20-02-05-004	PHMS, M4 X 8mm, Phillips, w/Captive Washer, Steel Black (Stainless)
3	1	B-16-301-0003	Face Plate Assembly, Remote, Switch Card, 8 Channel
2	1	B-17-001-0001	Enclosure, Remote Hand Held, Small, Yellow, 10' Tail
1	1	3500-02-03-00-002	Custom Label, Printable, B435/ Silver, TLS, 1.5" X .5", Y93431, 500pc Roll

PARTS LIST

motion laboratories 520 Furnace Dock Road Cortland Manor, NY 10567 <small>© 2007 Motion Laboratories, Inc. All Rights Reserved. THIS DOCUMENT IS THE EXCLUSIVE, CONFIDENTIAL PROPERTY OF MOTION LABORATORIES, INC. AND IT SHALL NOT BE REPRODUCED, COPIED, OR USED FOR ANY PURPOSE WHATSOEVER, UNLESS AND IN STRICT ACCORDANCE WITH THE TERMS AND CONDITIONS OF THE LICENSE AGREEMENT. ALL RIGHTS RESERVED. TO THE EXTENT SUCH IS EXPRESSLY AUTHORIZED BY MOTION LABORATORIES, INC. IN WRITING.</small>	TITLE	DRAWN BY	DATE DRAWN	SIZE	DRAWING NUMBER	REV
	Remote Hand Held, 8 Channel, Yellow, 10' Tail	GMF	7/21/2005	C	A-16-301-0003	A
	CHECKED BY	DATE CHECKED	SCALE	SHT		
			3/4	1	OF 2	
	MODEL FILENAME & PATH	M:\Assemblies\A-16-301-0003.iam				

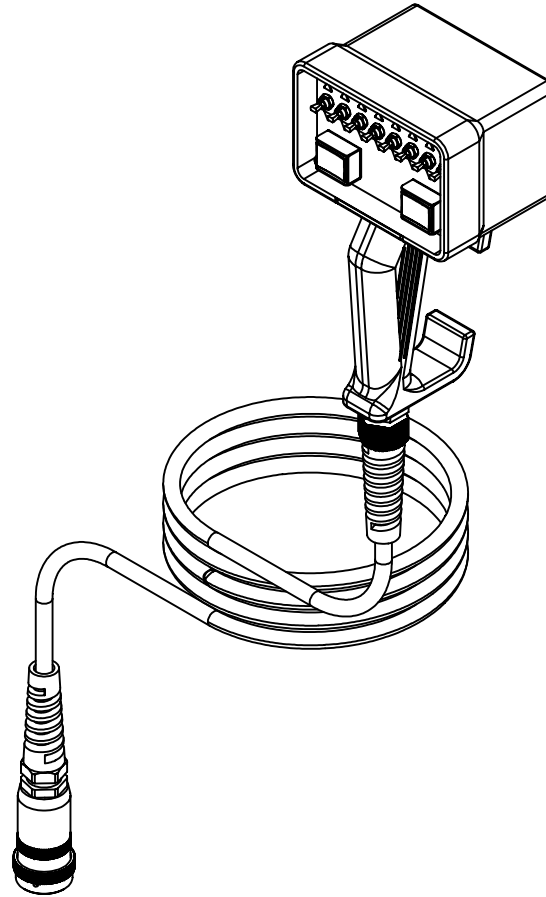
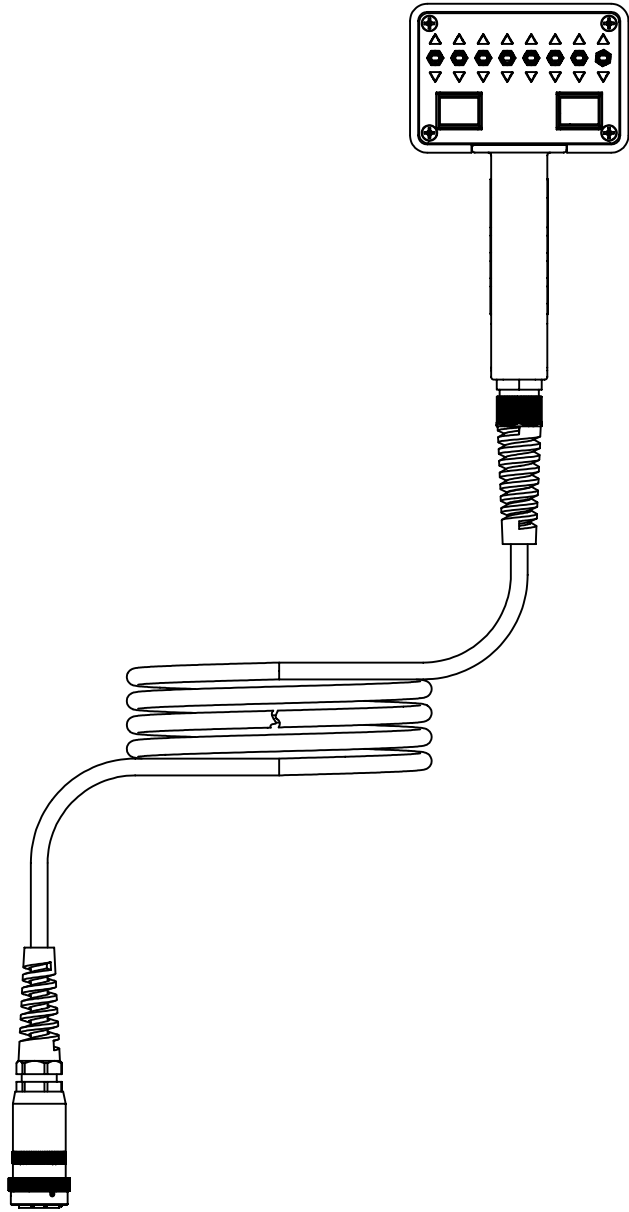

motionlaboratories
 520 Furnace Dock Road Cortland Manor, NY 10567

TITLE
 Remote Hand Held, 8 Channel,
 Yellow, 10' Tail

DRAWN BY
 GMF
 CHECKED BY

DATE DRAWN
 7/21/2005
 DATE CHECKED

SIZE
 C

DRAWING NUMBER
 A-16-301-0003

REV
 A

MODEL FILENAME & PATH
 M:\Assemblies\A-16-301-0003.iam

SCALE SHT
 2 OF 2