

Product Specifications: Shackle Pin Load*Cell

Functional Specification

The Motion Laboratories Shackle Pin Load*Cell shall be the primary load bearing component of the Motion Laboratories V3 Cell*Mate System. The Shackle Pin Load*Cell shall work in unison with the Cell*Mate Hub and Cell*Mate Touch Screen Display to monitor both dynamic and static loads. They shall be part of the A-17-003 Series.



Features

- The Shackle Pin Load*Cell shall be available in a load rating of 3.25 Metric Tons (7165 lbs) & 4.75 Metric Tons (10471 lbs).
- The Shackle Pin Load*Cell shall have a 5:1 safety factor.
- The Shackle Pin Load*Cell shall be assembled with Crosby G2130 Bolt Type Anchor Shackles.
- The Shackle Pin Load*Cell shall be assembled with 17-4PH Stainless Steel Pin, Nut & Bobbin.
- The Shackle Pin Load*Cell shall utilize a Wheatstone Bridge, to attain a high level of accuracy.
- The Shackle Pin Load*Cell shall have a 6-pin XLR data output connector.
- The Shackle Pin Load*Cell shall be RF Shielded to protect electronic components.
- The Shackle Pin Load*Cell shall transmit data via a digital signal, using RS485 communication protocol.
- The Shackle Pin Load*Cell shall require minimal maintenance.
- The Shackle Pin Load*Cell shall transmit data in 1 pound increments.
- The Shackle Pin Load*Cell shall be capable of measuring 1,200 times per second.¹
- The Shackle Pin Load*Cell shall be tested and certified to an accuracy of 2%.
- The Shackle Pin Load*Cell shall transmit data to a hub with a maximum cable length of 1000 feet.
- The Shackle Pin Load*Cell shall be assembled in the USA.

Physical Specifications

The Shackle Pin Load*Cell shall be made of 17-4PH Stainless Steel.

The Shackle Pin Load*Cell shall have a Housing made of 16 gauge 1020 Steel and have a dark gray sparkle metallic gloss smooth powder coat finish with yellow Motion Laboratories logo.

The Shackle Pin Load*Cell shall have a weight of 2.1 pounds (3.25 Metric Ton) & 3.2 pounds (4.75 Metric Ton).

The Shackle Pin Load*Cell shall have the following shackle sizes: 5/8" (3.25 Metric Ton), 3/4" (4.75 Metric Ton) &.

¹ The Load*Cell measures 1200 times per second capturing the peak load on the Load*Cell. The Cell*Mate Hub reads each channel's cell every 50 milliseconds and displays that load information on the Cell*Mate Touch Screen Display. Please see V3 system specification for any additional information.

Electrical Specifications

Unit Runs on 12VDC generated from the Cell*Mate Hub's internal switching power supply.

Environmental Specifications

For indoor use only

Ratings and Certifications

Motion Laboratories' Shackle Pin Load*Cell utilizes UL and/or UR components and is built to the standards of the National Electric Code (NEC).

The Motion Laboratories Cell*Mate Shackle Pin Load*Cell shall be tested to its full range using certified test equipment. This test results in a proof of performance certificate issued with each cell, indicating compliance with the listed specifications. In order to ensure their performance, the Load*Cell shall require annual recertification by a Motion Laboratories Certified Technician.

Shackle Pin Load*Cell, 3.25 Metric Ton (A-17-003-0006)

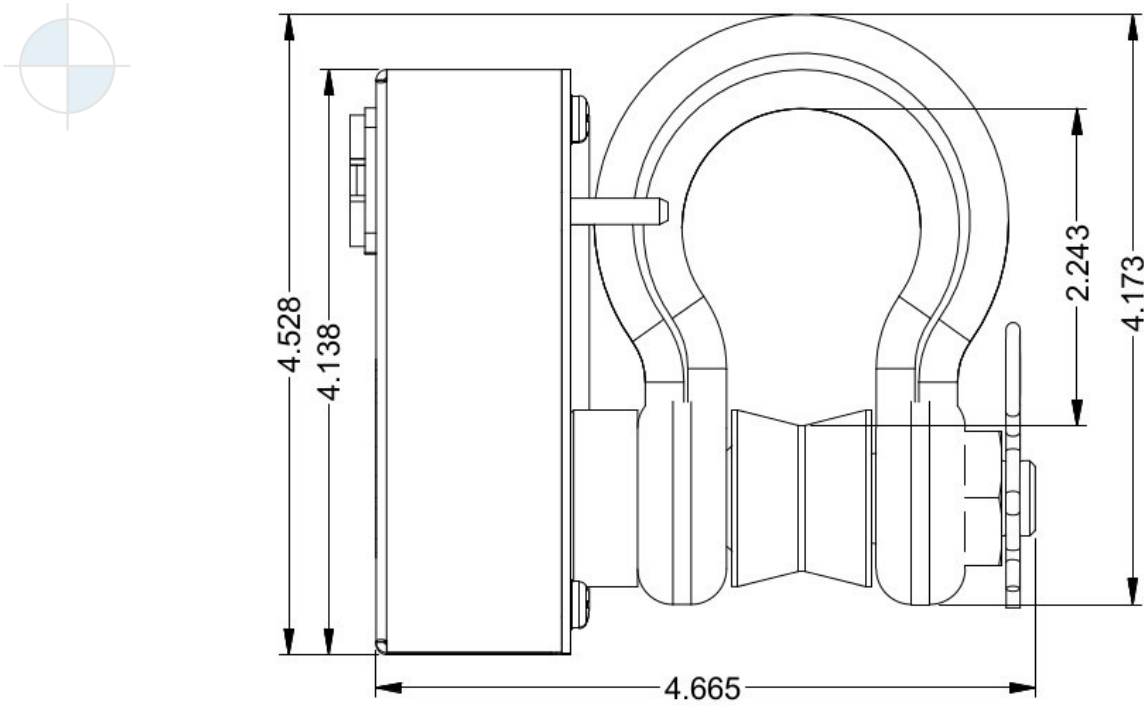

Shackle Pin Load*Cell, 4.75 Metric Ton (A-17-003-0007)

